

AURORA (DEEP)

UINTAH County of Utah

Effective Date: 6/29/2005

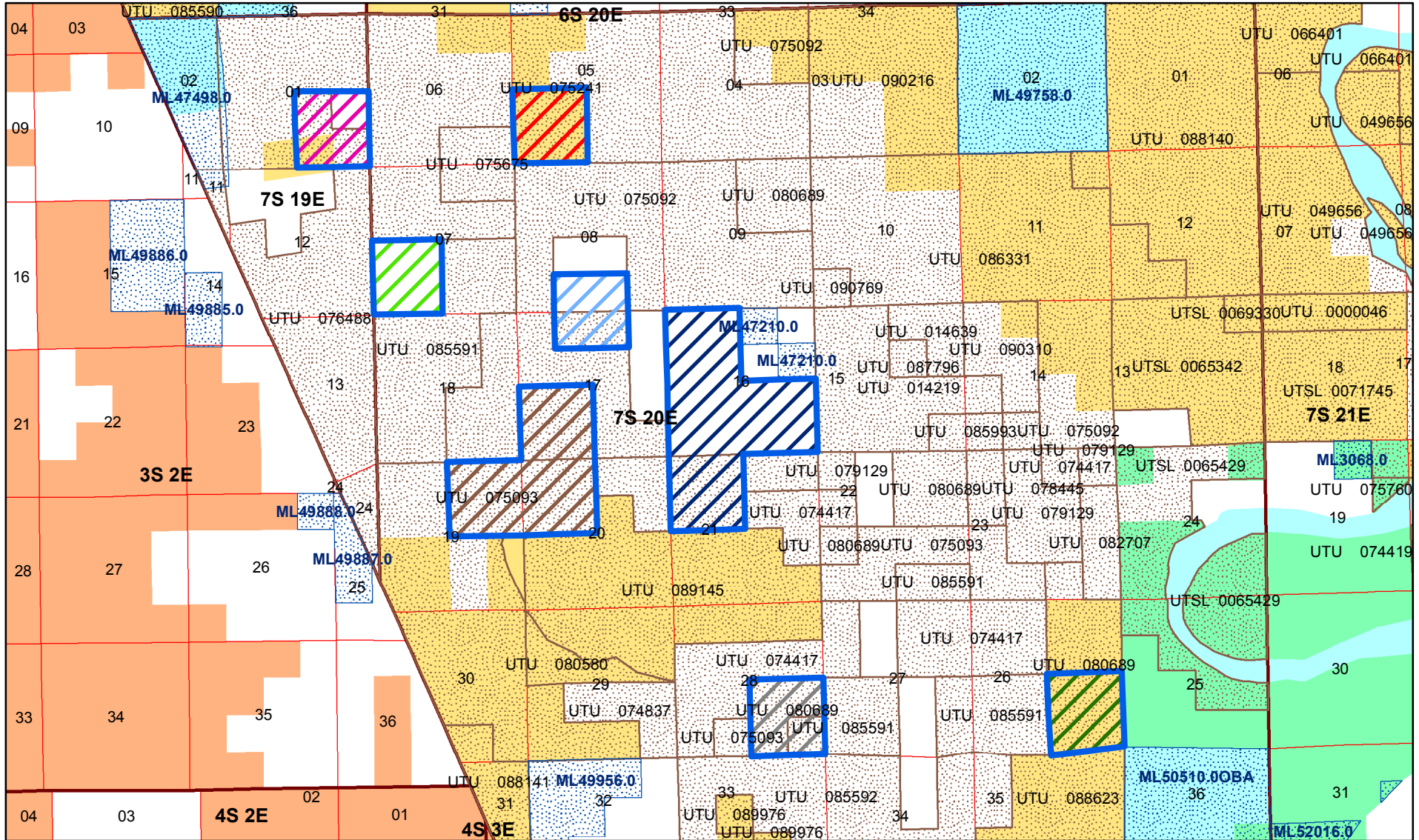

PA= Formation Name

- | | |
|--|--|
| PA= Green River-Wasatch "H"
UTU 082456J | PA= Green River-Wasatch "E"
UTU 082456G |
| PA= Green River-Wasatch "B"
UTU 082456D | PA= Green River-Wasatch "A-G"
UTU 082456K |
| PA= Green River-Wasatch "C"
UTU 082456E | PA= Green River-Wasatch "D"
UTU 082456F |
| PA= Green River-Wasatch "F"
UTU 082456H | PA= Green River "B"
UTU 082456B |

UTU 082456X

Acres: 2080.00

Oil and Gas Unit Agreement

- Oil and Gas Lease Parcels**
- Authorized Oil and Gas Lease Parcels
 - Pending Oil and Gas Lease Parcels
 - SITLA Oil and Gas Lease Parcels

- Bureau of Land Management (BLM)
- US Forest Service (USFS)
- National Park Service (NPS)
- Indian Reservation (IR)
- State
- Private
- Township
- Section

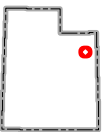
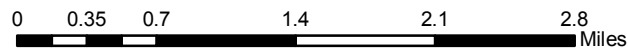

Date: 1/8/2018